

## STRAUB-ECO-GRIP Ø 26.9 - 168.3 mm

Components / Materials	W1	W2	W4	W5
Casing			AISI 301	
Bolts			A4 - 80	
Bars			AISI 316 L	
Anchoring rings			AISI 301	
Strip insert (option)			AISI 316 L	

**Sealing sleeve** Temp.: -10°C up to +40°C  
**EPDM** Medium: all qualities of water, waste water, air, solids and chemical products

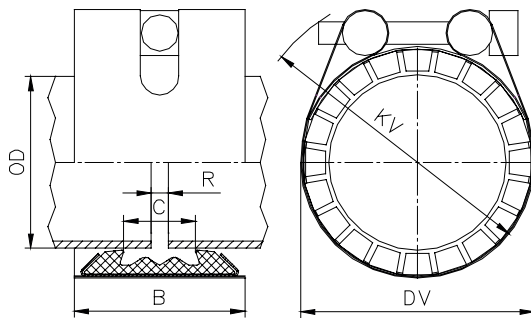

OD [mm]	Clamping range [mm]	PS [bar]	B [mm]	C [mm]	DV [mm]	KV [mm]	R without strip insert [mm]	R with strip insert [mm]	Torque rate [Nm]	Allen head [mm]	Thread M...
<b>26.9</b>	<b>26.4 - 27.4</b>	<b>6.0</b>	<b>45</b>	<b>18</b>	<b>41</b>	<b>70</b>	<b>5</b>	<b>10</b>	<b>10</b>	<b>6</b>	<b>8</b>
30.0	29.5 - 30.5	6.0	45	18	45	75	5	10	10	6	8
<b>33.7</b>	<b>33.2 - 34.2</b>	<b>6.0</b>	<b>45</b>	<b>18</b>	<b>48</b>	<b>75</b>	<b>5</b>	<b>10</b>	<b>10</b>	<b>6</b>	<b>8</b>
38.0	37.5 - 38.5	6.0	45	18	52	90	5	10	10	6	8
<b>42.4</b>	<b>41.9 - 42.9</b>	<b>6.0</b>	<b>45</b>	<b>18</b>	<b>56</b>	<b>95</b>	<b>5</b>	<b>10</b>	<b>12</b>	<b>6</b>	<b>8</b>
44.5	44.0 - 45.0	6.0	45	18	59	95	5	10	12	6	8
48.0	47.5 - 48.5	6.0	45	18	62	95	5	10	15	6	8
<b>48.3</b>	<b>47.8 - 48.8</b>	<b>6.0</b>	<b>45</b>	<b>18</b>	<b>62</b>	<b>100</b>	<b>5</b>	<b>10</b>	<b>15</b>	<b>6</b>	<b>8</b>
57.0	56.4 - 57.6	6.0	60	26	71	105	5	10	15	6	8
58.0	57.5 - 58.5	6.0	60	26	73	106	5	10	15	6	8
<b>60.3</b>	<b>59.7 - 60.9</b>	<b>6.0</b>	<b>60</b>	<b>26</b>	<b>76</b>	<b>110</b>	<b>5</b>	<b>10</b>	<b>15</b>	<b>6</b>	<b>8</b>
63.0	62.2 - 63.8	6.0	60	26	68	114	5	10	15	6	8
<b>76.1</b>	<b>75.3 - 76.9</b>	<b>6.0</b>	<b>60</b>	<b>26</b>	<b>92</b>	<b>142</b>	<b>5</b>	<b>10</b>	<b>18</b>	<b>6</b>	<b>8</b>
78.0	77.1 - 78.8	6.0	60	26	95	145	5	10	18	6	8
83.0	82.1 - 83.8	6.0	60	26	101	151	5	10	18	6	8
<b>88.9</b>	<b>88.0 - 89.8</b>	<b>6.0</b>	<b>60</b>	<b>26</b>	<b>108</b>	<b>157</b>	<b>5</b>	<b>10</b>	<b>18</b>	<b>6</b>	<b>8</b>
104.0	103.0 - 105.0	6.0	60	26	120	172	5	10	18	6	8
108.0	106.9 - 109.1	6.0	60	26	124	172	5	10	18	6	8
<b>114.3</b>	<b>113.2 - 115.4</b>	<b>6.0</b>	<b>60</b>	<b>26</b>	<b>130</b>	<b>177</b>	<b>5</b>	<b>10</b>	<b>18</b>	<b>6</b>	<b>8</b>
133.0	131.7 - 134.3	6.0	62	26	149	200	5	10	30	8	10
135.0	133.7 - 136.3	6.0	62	26	152	204	5	10	30	8	10
<b>139.7</b>	<b>138.3 - 141.1</b>	<b>6.0</b>	<b>62</b>	<b>26</b>	<b>156</b>	<b>210</b>	<b>5</b>	<b>10</b>	<b>30</b>	<b>8</b>	<b>10</b>
159.0	157.4 - 160.6	6.0	62	26	177	225	5	10	35	8	10
160.0	158.4 - 161.6	6.0	62	26	179	226	5	10	35	8	10
<b>168.3</b>	<b>166.6 - 170.0</b>	<b>6.0</b>	<b>62</b>	<b>26</b>	<b>185</b>	<b>230</b>	<b>5</b>	<b>10</b>	<b>35</b>	<b>8</b>	<b>10</b>

### Remarks:

- Follow fitting / disassembly instructions
- PS = Working pressure considering the application loads  
Test pressure = PS x 1.5 (for example industry, water supply etc.)
- The pressure values are valid on radial rigid carbon steel pipes under static loads
- For minimum wall-thickness of pipe, see technical manual
- Strip inserts are required for special applications

For IPS sizes in bold see technical manual for actual OD

Typing errors may occur. Technical details are subject to change