



Simple, safe, tight – STRAUB-CLAMP®



NEW

straub® 
the original

an OAliaxis company

STRAUB-CLAMP® SCE 44.0 – 330.0 mm One-piece repair clamp

Components	Materials
Casing	1.4301 / 304
Screws	1.4301 / 304
Bolts	1.4301 / 304
Sealing sleeve	Temp.: -5°C to +25°C
NBR	Medium: all water qualities, gas

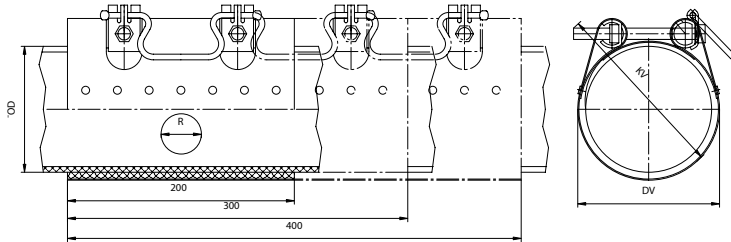

DN	OD (mm)	Working pressure* PS (bar)	Tightening torque (Nm)	clamp length			KV on largest pipe (mm)	Hex head (mm)	Thread (mm)	
				2 locking bolts	3 locking bolts	4 locking bolts				
44	44 - 48	16	40 ±2	200	300		60	117	17	M10
48	48 - 52	16	45 ±2	200	300		64	120	17	M10
54	54 - 58	16	45 ±2	200	300		70	125	17	M10
60	60 - 67	16	45 ±2	200	300		79	127	17	M10
70	70 - 77	16	45 ±2	200	300		89	135	17	M10
75	75 - 81	16	60 ±3	200	300		95	138	17	M10
82	82 - 89	16	60 ±3	200	300	400	101	145	17	M10
87	87 - 95	16	60 ±3	200	300	400	107	149	17	M10
88	88 - 95	16	60 ±3	200	300	400	110	148	17	M10
95	95 - 104	16	60 ±3	200	300	400	116	155	17	M10
108	108 - 118	16	60 ±3	200	300	400	120	166	17	M10
113	113 - 123	16	60 ±3	200	300	400	135	171	17	M10
118	118 - 128	16	60 ±3	200	300	400	140	175	17	M10
120	120 - 131	16	60 ±3	200	300	400	143	176	17	M10
132	132 - 142	16	70 ±3	200	300	400	154	188	19	M12
135	135 - 145	16	70 ±3	200	300	400	157	191	19	M12
139	139 - 149	16	70 ±3	200	300	400	161	195	19	M12
145	145 - 155	16	70 ±3	200	300	400	167	201	19	M12
159	159 - 170	16	80 ±5	200	300	400	182	214	19	M12
167	167 - 178	16	80 ±5	200	300	400	190	221	19	M12
176	176 - 187	16	80 ±5	200	300	400	199	230	19	M12
193	193 - 203	16/10	80 ±5	200	300	400	215	247	19	M12
215	215 - 225	10	80 ±5	200	300	400	237	268	19	M12
228	228 - 239	10	85 ±5		300		251	281	19	M12
240	240 - 250	10	85 ±5		300		262	292	19	M12
261	261 - 271	10	85 ±5		300		283	313	19	M12
269	269 - 280	10	85 ±5		300		292	321	19	M12
280	280 - 291	10	85 ±5		300		303	332	19	M12
315	315 - 325	6	85 ±5		300		337	366	19	M12
320	320 - 330	6	90 ±9		300		342	371	19	M12

Legend:

- R = Maximum axial length of damaged area
- Radial length of damaged area max. 20% of pipe outside diameters
- The repair clamp must be centred over the damaged area

* Working pressure for gas max 5 bar

Clamp length	200 mm	300 mm	400 mm
R =	50 mm	150 mm	250 mm

Remarks:

- The clamp cannot be used for differing pipe diameters (transitions)
- Test pressure = 1.5 x PS
- Comply with installation instructions

STRAUB-CLAMP® SCZ 88.0 – 440.0 mm Two-piece repair clamp

Components	Materials
Casing	1.4301 / 304
Screws	1.4301 / 304
Bolts	1.4301 / 304
Sealing sleeve	Temp.: -5°C to +25°C
NBR	Medium: all water qualities, gas

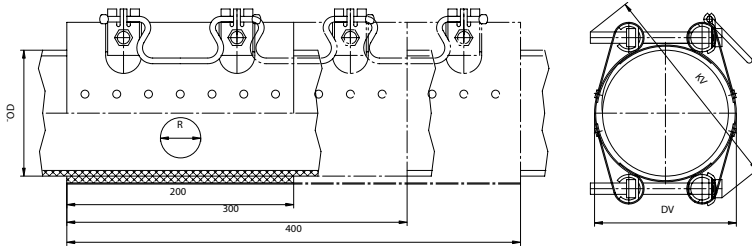

DN	OD (mm)	Working pressure* PS (bar)	Tightening torque (Nm)	clamp length			DV on largest pipe (mm)	KV on largest pipe (mm)	Hex head (mm)	Thread
				2 locking bolts	3 locking bolts	4 locking bolts				
88	88 - 108	16	60 ±3	200	300	400	117	186	17	M10
100	100 - 120	16	60 ±3	200	300	400	132	197	17	M10
108	108 - 128	16	60 ±3	200	300	400	140	204	17	M10
114	114 - 134	16	60 ±3	200	300	400	146	209	17	M10
120	120 - 140	16	70 ±3	200	300	400	152	215	17	M10
130	130 - 150	16	70 ±3	200	300	400	162	228	19	M12
140	140 - 160	16	70 ±3	200	300	400	172	237	19	M12
159	159 - 180	16	80 ±5	200	300	400	192	255	19	M12
168	168 - 189	16	80 ±5	200	300	400	201	264	19	M12
190	190 - 210	16	80 ±5	200	300	400	222	284	19	M12
210	210 - 230	10	80 ±5	200	300	400	242	303	19	M12
218	218 - 238	10	80 ±5	200	300	400	252	312	19	M12
240	240 - 260	10	85 ±5	200	300	400	272	332	19	M12
269	269 - 289	10	85 ±5	200	300	400	301	360	19	M12
282	282 - 302	10	85 ±5	200	300	400	314	373	19	M12
315	315 - 335	10/6	85 ±5	200	300	400	347	405	19	M12
322	322 - 344	6	85 ±5		300	400	356	413	19	M12
337	337 - 358	6	85 ±5		300	400	370	427	19	M12
347	347 - 367	5	95 ±5		300	400	379	436	19	M12
365	365 - 385	5	95 ±5			400	397	453	19	M12
410	410 - 430	5	95 ±5			400	442	498	19	M12
420	420 - 440	5	95 ±5			400	452	508	19	M12

Legend:

- R = Maximum axial length of damaged area
- Radial length of damaged area max. 20% of pipe outside diameters
- The repair clamp must be centred over the damaged area

* Working pressure for gas max 5 bar

Clamp length	200 mm	300 mm	400 mm
R =	50 mm	150 mm	250 mm

Remarks:

- The clamp cannot be used for differing pipe diameters (transitions)
- Test pressure = 1.5 x PS
- Comply with installation instructions

STRAUB-CLAMP®-repair clamps

One and two-piece clamps for the safe, reliable repair of gas, water and drainage pipes made from a range of materials.

Applications

STRAUB-CLAMP® repair clamps for safely and reliably sealing damaged pipes made from a range of materials (steel, cast iron, ductile cast iron, fibre cement, PVC). Available in sizes from DN 40 to DN 400. Also obtainable as a two-piece version, STRAUB-CLAMP® repair clamps with the standard NBR sealing sleeve can be used on water, drainage pipes and gas.

Working instructions

STRAUB-CLAMP® provides a safe, reliable way of sealing damaged pipes.

The repair clamp must be at least as long as the outside diameter of the pipe being repaired.

Prepare the pipe surfaces in accordance with the general installation requirements (refer to STRAUB-CLAMP® installation instructions).

Gas: permitted working pressure 5 bar (\leq DN 300)

Water: permitted working pressure

\leq DN 200 PN 16

$>$ DN 200 PN 10

$>$ DN 300 on request

Ten good reasons to opt for STRAUB-CLAMP®

1. Ideal for repairing large damaged areas up to 250 mm long.
2. The large-surface waffle profile reduces the required tightening torque, extending the life of the rubber.
3. One size (OD) spans a wide range (up to 20 mm).
4. Integrated ergonomic hand grips for easy handling.
5. No loose screws or parts when opening. Both the one-piece and two-piece repair clamps are complete units.
6. High level of corrosion resistance. Modern manufacturing methods, including pressure jointing, prevent changes in the material structure and stresses in the material.
7. The entire repair clamp is made from stainless steel.
8. The stainless steel screws are coated with Delta Seal, ensuring smooth tightening to the specified torque.
9. Installation with standard tools (torque wrench with hex socket) – without extensions.
10. Swiss quality product

Liability Disclaimer

The information contained herein may include inaccuracies or typographical errors. In addition, changes are periodically made to this information. Straub may make such changes to this information at any time without notice to the user.

Marine Ventures Ltd, Marven House, 1 Field Road, Reading, RG1 6AP, UK

Tel: +44-(0)118-950-3707, Fax: +44-(0)118-950-4066, www.straub.co.uk, info@straub.co.uk

